

# LED Flat Panel Light

## FEATURES AND SPECIFICATIONS

### Construction

- Integrative aluminum frame provides a durability structure
- 5 Wattage and 5 CCT selectable switches are integrated on the driver
- Minimize Stock, 1SKU can cover Max. of 25 Models

### Electrical

- Input Voltage: 120-277Vac 50/60Hz
- 0-10V dimming
- THD≤20%, PF≥0.9

### Applications

- Offices, retail, schools, restaurants, healthcare, residential, and hospitality applications.

### Installation

- Fixture is suitable for recessed mounting with T-bar, and accessories for suspension and surface mounting are also available. Use in ambient temperatures ranging from -20°C to 45°C

### Listing

- ETL listed, suitable for damp location.
- DesignLights Consortium ®(DLC)Premium.

### Warranty

- 5-year limited warranty



Specs at a Glance		* Nominal Wattage (Switchable)	
Configuration	2x2 FT	2x4 FT	1 x4 FT
CCT (K)	3500K-4000K-5000K-5700K-6500K(Switchable)		
Wattage (W)*	15W/20W/25W/ 30W/40W Wattage Adjustable	30W/40W/50W/ 60W/72W Wattage Adjustable	15W/20W/25W/ 30W/40W Wattage Adjustable
Lumens (lm)	1,950-5,000LM	3,900-9,000LM	1,950-5,000LM
Efficacy (LPW)	Up to 125	Up to 125	Up to 125
CRI	≥80		
Input Voltage	120-277VAC, 50/60Hz, 0-10V Dimming		
Operating Temp	-20°C to 45°C		
Certifications	ETL DLC 5.1 Premium		
Warranty	5 Years		

# LED Flat Panel Light

## Ordering information

Model	Description
CL-B2-S40-3565-(blank,-S)	2' x 2' Backlit Panel, Power Switchable 15W/20W/25W/30W/40W, Color Switchable 3500K/4000K/5000K/5700K/6500K, Sensor Base
CL-B4-S72-3565-(blank,-S)	2' x 4' Backlit Panel, Power Switchable 30W/40W/50W/60W/72W, Color Switchable 3500K/4000K/5000K/5700K/6500K, Sensor Base
CL-B14-S40-3565-(blank,-S)	1' x 4' Backlit Panel, Power Switchable 15W/20W/25W/30W/40W, Color Switchable 3500K/4000K/5000K/5700K/6500K, Sensor Base

## Multiple Sensor Solutions

Quick and Easy in-field installation of sensors.



( The sensor receptacle is pre-embedded in the profile frame. )



## Multiple Emergency Solutions



## Sensor

Model Number	Sensor Type	Connector	Controller
HD08VR-M-1	Microwave	Audio Jack	Remote Control HD06R
HD08VR-MB-1 	Microwave		HAISEN BLUE APP
HD08VR-PB-1	PIR		Remote Control HD06R
HD08VR-PB-1 	PIR		HAISEN BLUE APP

## Emergency LED Driver



- Emergency LED Driver, 9W, 90-Min Battery
- Emergency LED Driver, 15W, 90-Min Battery



# LED Flat Panel Light

## Flexible Installation Options

### Cable Mount Kit

Optional Y cable mounting kit allows for suspended installations from any ceiling type. (2 pcs/kit)

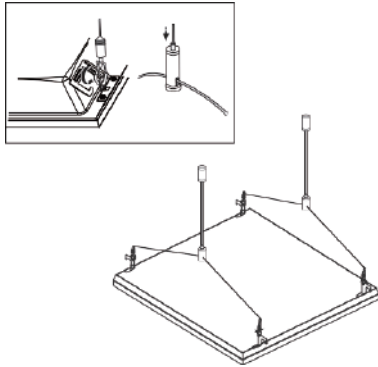

### Surface Mount Kit

Optional surface mount kit allows for installation on plaster or other hard ceilings.

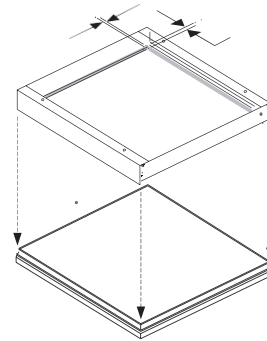

## Installation Instruction

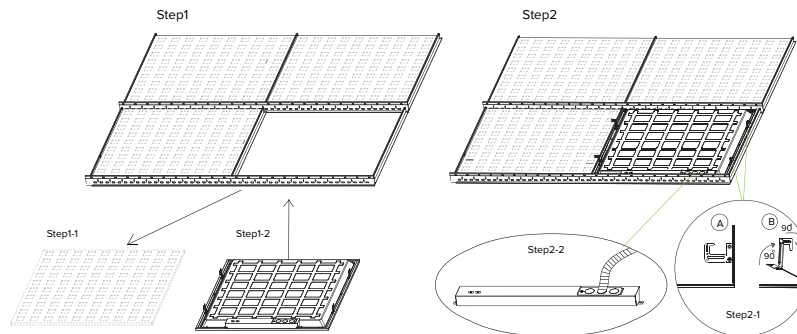

## Packing Information

Size/ft	L /inch	W /inch	H /inch	QTY/ctn	G.W./lbs	CTN QTY/pallet
2x2'	25.2	25.2	6.1	4	16.23	144pcs
2x4'	49.4	25.2	6.1	4	39.30	72pcs
1x4'	49.4	13.7	6.1	4	20.2	144pcs